



FALMOUTH HISTORICAL COMMISSION

03 April 2018

WHOI Institutional Identity

1 institution **2** campuses **5** districts



“The **ocean** is at the center of **what we do** and **where we are...**”



WHOI Facilities

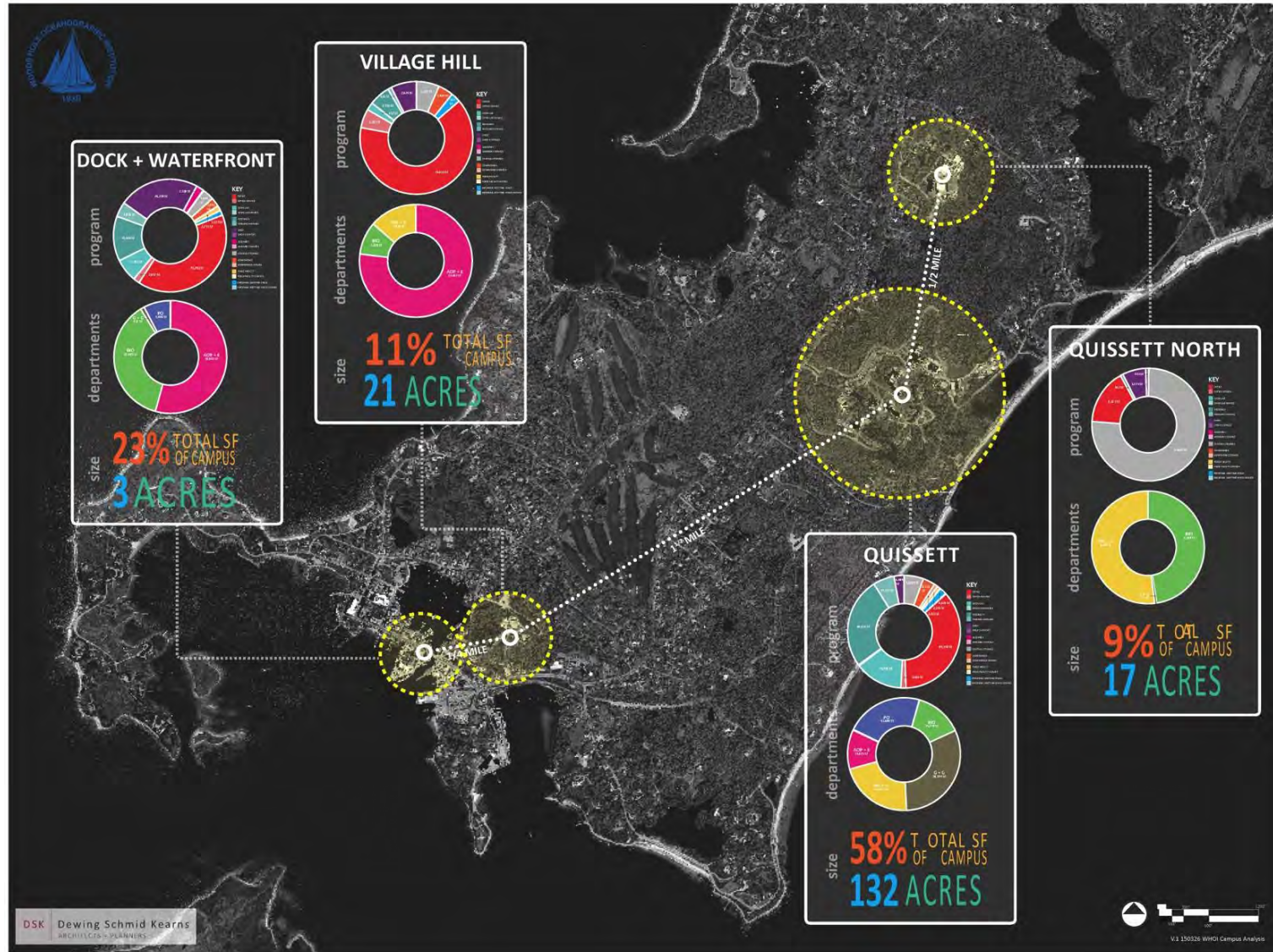

SFA Tier 1 Planning Drivers

The goal of the SFA is to determine what we need and will need to move WHOI into the future.

1 Waterfront

2 Quissett Campus

3 Village Campus



1. Waterfront

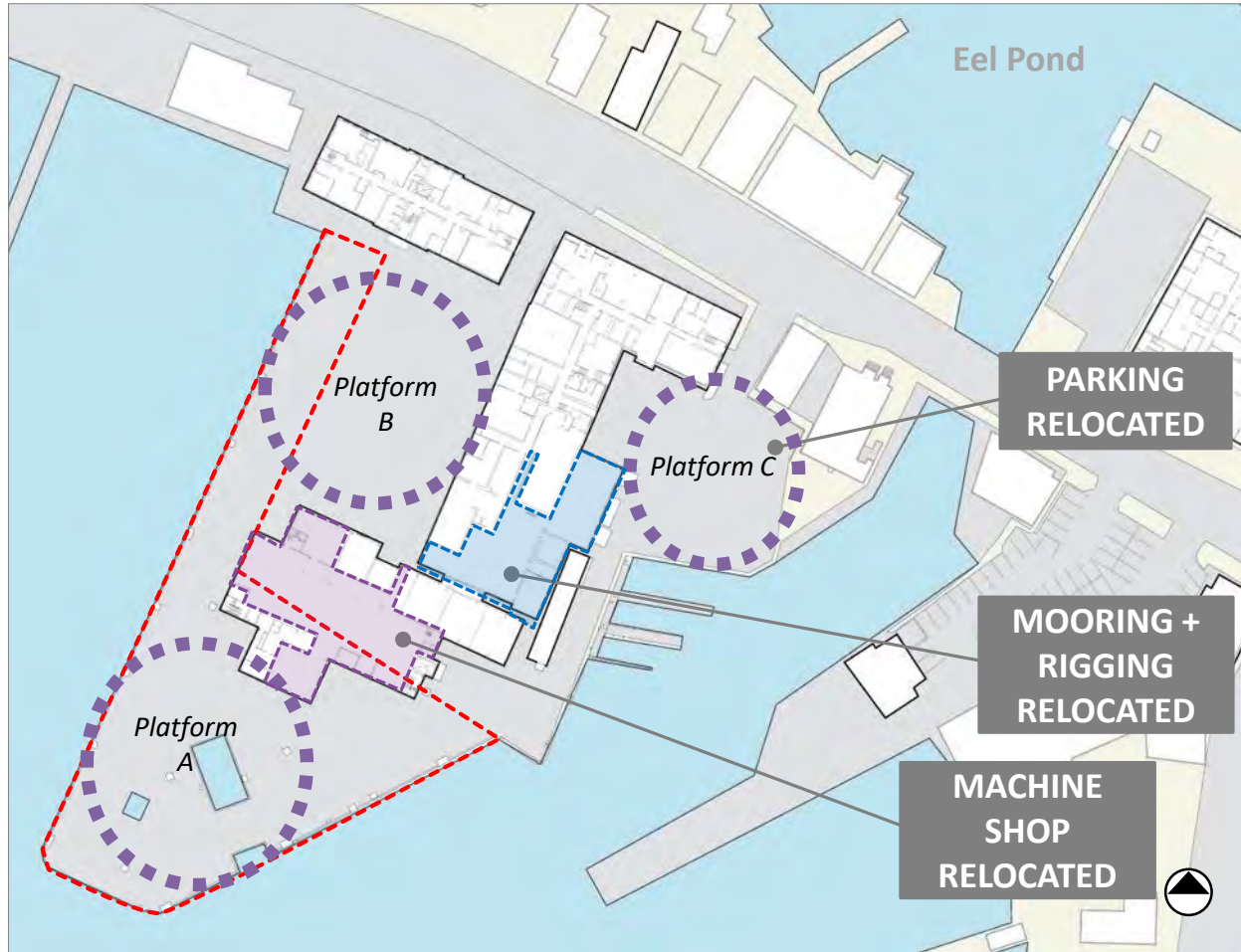

“The **ocean** is at the center of **what we do** and **where we are...**”

OBJECTIVES

1. Enable replacement of the Main Dock to continue to support ships and research initiatives
2. Relocate Mooring + Rigging and Machine Shop from Main Dock
3. Relocate parking

2. Quissett Campus



OBJECTIVES

1. Relocate Mooring + Rigging and Machine Shop from Main Dock
2. Evaluate 50-75 year land-use strategies for the Quissett Campus

3. Village Campus



Existing Parking & Transportation



Existing Conditions: Parking



Existing Conditions



Existing Conditions: Landscapes



Proposal to Community- Feb 27, 2018



Initial Proposed Plan

OBJECTIVES

1. Improve safety, improve circulation, create better access to parking, and reduce WHOI traffic on Water St.
2. Add parking in the Village to reduce the need for parking on the Main Dock (318 total)
3. Improve signage on the Village Campus to support improved wayfinding, safety, and traffic patterns

What we heard at Community Meeting

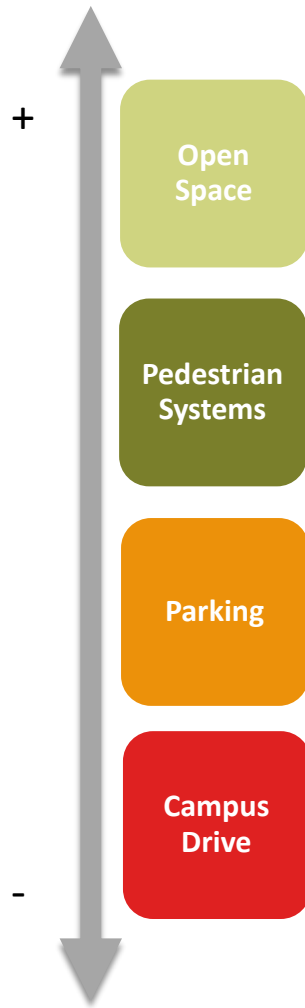

- Preservation of open space
- Legacy of shared use
- Significant open space in Woods Hole
- Opportunities to improve pedestrian systems
- Limit impact of lighting systems
- Remove campus drive element
- Leverage other modes of transportation

Proposed Plan



Proposed Plan (enlarged)



Proposed Plan- Overlay existing



Proposed Plan- Overlay existing (enlarged)

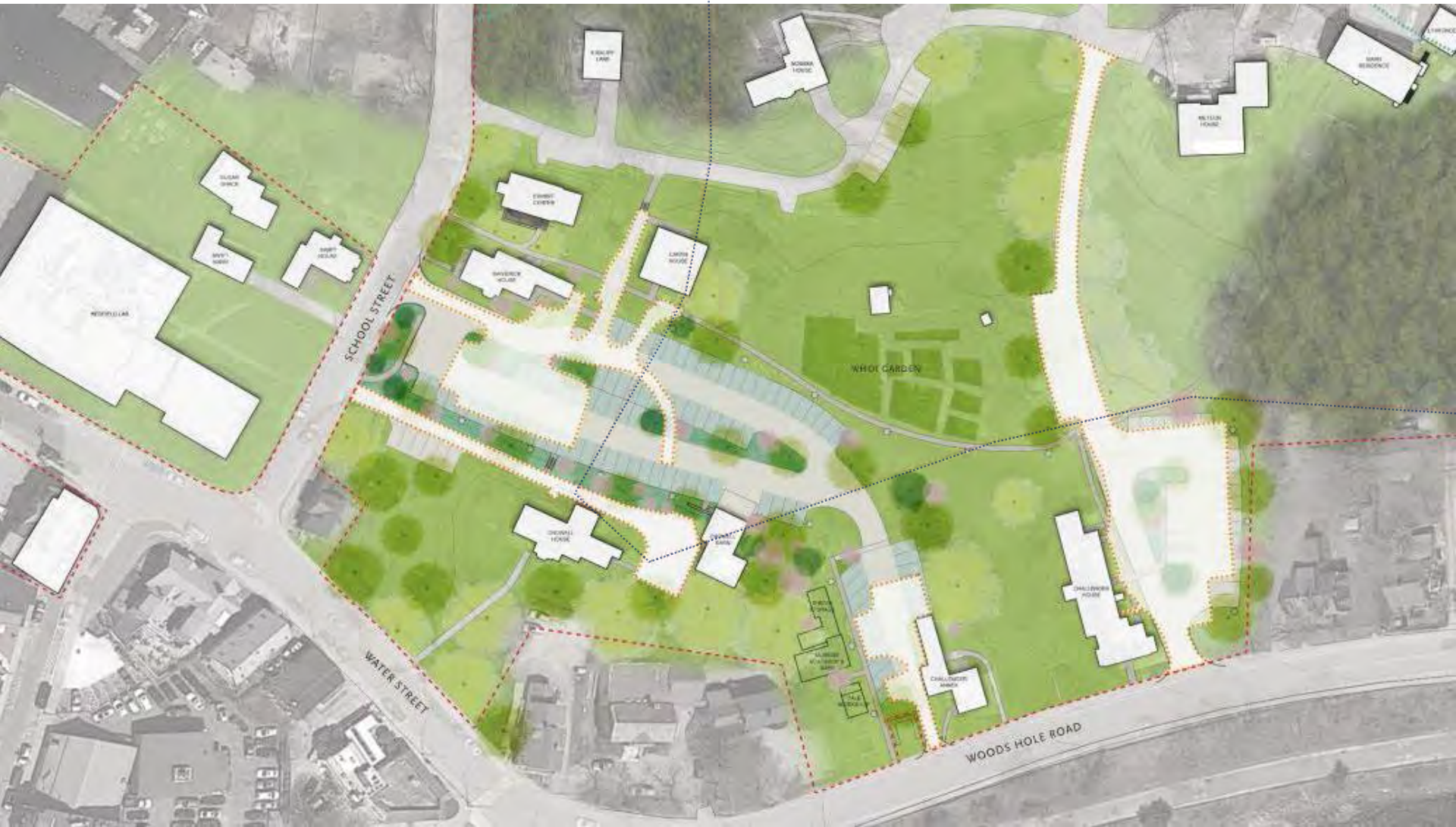

Sustainable Strategies



Existing Conditions- School St.



Proposed- School St.



Proposed Signage



Proposed Landscapes

